

Technical data sheet

Actuator sensor interface · M8 - connector

Field wireable connector, M8 straight

Male / female

Screw terminal



Identification

Type KUGK-M8 4 POL. SK
Part No. [490059](#)

Product version

Datasheet version 00

General

Design	M 8 female straight
Test voltage	1500 V
Degree of pollution	3
Insulation resistance	>10000 MΩ
Contact resistance	<3 mΩ
Flamability according to UL 94	HB
Degree of protection	IP67
Housing material	PBT
Color of the housing	black
Contact material	CuZn, gold-plated
Thread material	CuZn nickel-plate
Material sealing ring	NBR
Mounting	Breakaway torque 0.2 Nm
Cable diameter	3.5 mm – 5 mm
Storage temperature range	-40 °C ... +90 °C
Temperature range connector	-25 °C ... +85 °C

United Kingdom: LÜTZE Ltd.

Unit 3, Sandy Hill Park
Sandy Way, Amington • GB-Tamworth, Staffs B77 4DU
Tel. +44 (0)1827 31333-0 • Fax +44 (0)1827 31333-2
www.lutze.com • sales.gb@lutze.co.uk

Germany: Friedrich Lütze GmbH

Postfach 12 24 (PLZ 71366) • Bruckwiesenstraße 17-19 • D-71384 Weinstadt
Tel. +49 (0)7151 6053-0 • Fax +49 (0)7151 6053-277(-288)
www.luetze.de • info@luetze.de

03.05.2022 • Subject to technical modification

Part No. [490059](#) • Datasheet version: 00

page 1 of 3



SYSTEMATIC TECHNOLOGY

Technical data sheet

Actuator sensor interface · M8 - connector

Mechanical service life	>100 insertion cycles
Connection type	Screw terminal
	0.14 mm ² – 0.5 mm ²
Weight/unit	0.04 kg
PU (units)	1

Technical data

Rated voltage U _N	AC/DC 24 V
Operating voltage max.	60 V
Rated current	4 A
Pole number	4

Certifications/Standards

Certifications	cULus Listed (E224249)
----------------	------------------------

Equipment/Spare parts

Accessories

matching cables:

117240		SU TR AS PUR 3×0,25 UL		Jacket material: PUR
117241		SU TR AS PUR 4×0,25 UL		Jacket material: PUR
117243		SU TR AS PUR 3×0,34 UL		Jacket material: PUR
117244		SU TR AS PUR 4×0,34 UL		Jacket material: PUR

Dimensions

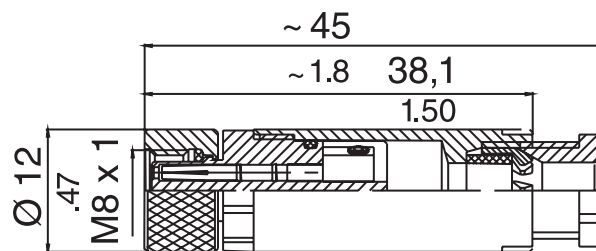

Mounting diagram

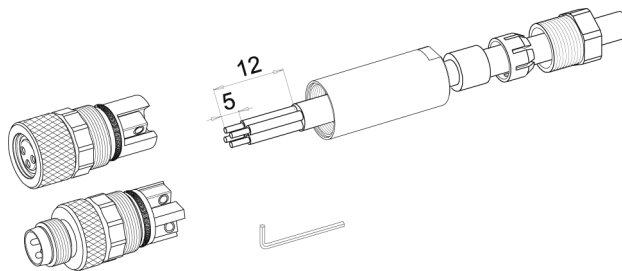

Technical data sheet

Actuator sensor interface · M8 - connector

Pin layout

