

## Technical data sheet

Actuator sensor interface · M8 - connector

---

Field wireable connector, M8 straight

Male / female

Screw terminal



---

### Identification

Type STGK-M8 4 POL. SK  
Part No. [490057](#)

---

### Product version

Datasheet version 00

---

### General

Design	M 8 male straight
Test voltage	1500 V
Degree of pollution	3
Insulation resistance	>10000 M $\Omega$
Contact resistance	<3 m $\Omega$
Flamability according to UL 94	HB
Degree of protection	IP67
Housing material	PBT
Color of the housing	black
Contact material	CuZn, gold-plated
Thread material	CuZn nickel-plate
Mounting	Breakaway torque 0.2 Nm
Cable diameter	3.5 mm – 5 mm
Storage temperature range	-40 °C ... +90 °C
Temperature range connector	-25 °C ... +85 °C
Mechanical service life	>100 insertion cycles

---

#### United Kingdom: LÜTZE Ltd.

Unit 3, Sandy Hill Park  
Sandy Way, Amington · GB-Tamworth, Staffs B77 4DU  
Tel. +44 (0)1827 31333-0 · Fax +44 (0)1827 31333-2  
[www.lutze.com](http://www.lutze.com) · [sales.gb@lutze.co.uk](mailto:sales.gb@lutze.co.uk)

#### Germany: Friedrich Lütze GmbH

Postfach 12 24 (PLZ 71366) · Bruckwiesenstraße 17-19 · D-71384 Weinstadt  
Tel. +49 (0)7151 6053-0 · Fax +49 (0)7151 6053-277(-288)  
[www.luetze.de](http://www.luetze.de) · [info@luetze.de](mailto:info@luetze.de)

03.05.2022 · Subject to technical modification

Part No. [490057](#) · Datasheet version: 00

page 1 of 2



SYSTEMATIC TECHNOLOGY

## Technical data sheet

### Actuator sensor interface · M8 - connector

Connection type	Screw terminal 0.14 mm <sup>2</sup> – 0.5 mm <sup>2</sup>
Weight/unit	0.04 kg
PU (units)	1

#### Technical data

Rated voltage U <sub>N</sub>	AC/DC 24 V
Operating voltage max.	60 V
Rated current	4 A
Pole number	4

#### Certifications/Standards

Certifications	cULus Listed (E224249)
----------------	------------------------

#### Equipment/Spare parts

##### Accessories

##### matching cables:

117240	SU TR AS PUR 3×0,25 UL	Jacket material: PUR
117241	SU TR AS PUR 4×0,25 UL	Jacket material: PUR
117243	SU TR AS PUR 3×0,34 UL	Jacket material: PUR
117244	SU TR AS PUR 4×0,34 UL	Jacket material: PUR

#### Dimensions

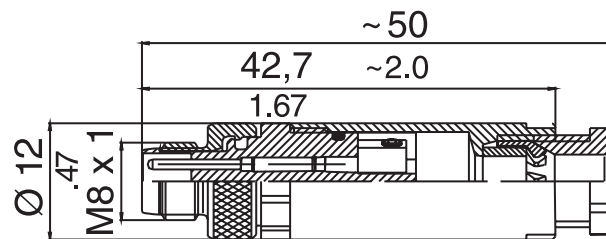

#### Mounting diagram

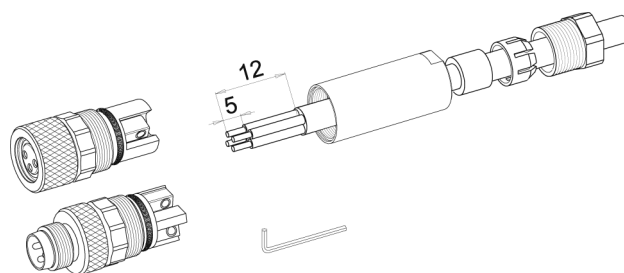

#### Pin layout

