

LUMOTAST 75 IP40 Illuminated pushbutton, flush lens, rectangular collar

Technical data see page 1 - 37

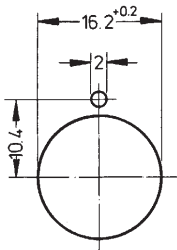

Panel cut-out

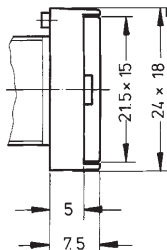

1

LUMO
75 (40)

→ Contact arrangement	Contact function	Color of collar	Order no.	Note
1 NC + 1 NO	momentary	black	1.15.108.051/0000	Please include the desired lens and diffuser in your order.
1 NC + 1 NO	latching	black	1.15.108.151/0000	Please include the desired lens and diffuser in your order.
2 NC + 2 NO	momentary	black	1.15.108.052/0000	Please include the desired lens and diffuser in your order.
2 NC + 2 NO	latching	black	1.15.108.152/0000	Please include the desired lens and diffuser in your order.

Lenses:

Lens, rectangular, transparent colorless, for LED: 5.49.275.032/1002

Lens, rectangular, transparent red, for LED: 5.49.275.032/1301

Lens, rectangular, transparent yellow, for LED: 5.49.275.032/1402

Lens, rectangular, transparent green, for LED: 5.49.275.032/1503

Diffuser, rectangular, for LED, without legend: 5.73.012.000/0214

Accessoires:

LUMOTAST 75 IP40 - Protective cap for 18 x 24 collar: 5.05.800.027/0000

LUMOTAST 75 IP40 - Sealing cap for protection class IP65, for 18 x 24 collar: 5.05.200.008/0000